

POWER PLUG

USER GUIDE

ZIGBEE

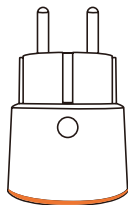

Product Configuration

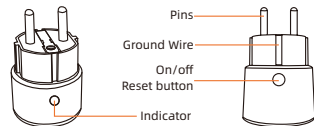

Install

1. Insert plug pins into socket
2. Configure the device to app
3. Turn on/off switch

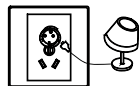

Feature & Specifications

Input: 85~250VAC, 50/60Hz
Maximum current: 16A
Overload protection: 16A
Standby power: 0.5W
Working Temperature: 0°C ~ 40°C (32°F ~ 104°F)
Working Humidity: 20% ~ 85% non-condensing
Wireless Range: 55m
Wireless Frequency: 2.4GHz
Communication protocol: Zigbee 3.0
Networking protocol: Zigbee IEEE 802.15.4
Product size: 46mm x 46mm x 71mm



Indicator Status

1. waiting configuration mode: Led flashes quickly(2 times/second)
the device is default to enter waiting configuration mode when connected to power source.
2. On/off: Led indicator on/off
3. Reset: long press the on/off button for 5-7 seconds then device will be reset successfully, also will be deleted from app.

Get Started

1. Download APP

Download the "Smart life" app from APP Store or Google Play to your mobile.



2. Register and Login

- A. Launch the "Smart life" app.
- B. To register, enter your phone number or email address, create a password, then login to the app.
- C. Login if you have an account already.

Add ZigBee Controller(Gateway)

Add Tuya ZigBee controller first and operate with the controller user manual. (Please notice the wired and wireless version controller)

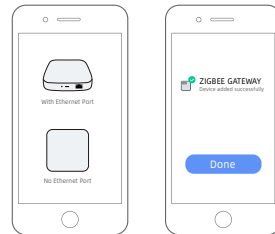

Note: The diagram is for reference only. (UI maybe different in other APP version)

Add Sub-device

Add the ZigBee Sub-device

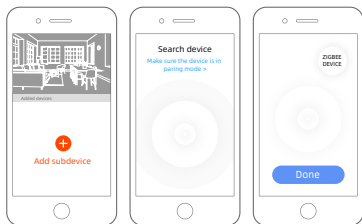

Note: The diagram is for reference only. (UI maybe different in other APP version)

Configure the network successfully

When the sub-device is successfully added, the main user interface of the APP is displayed as follows:



Advanced Features

You can experience the various advanced features of the device with the app, just try and do it yourself.

1. on/off status display
2. Countdown on/off, Timing switch, Cyclic timing, Random timing



3. Power meter

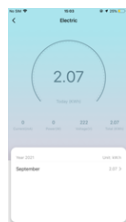

4. Setting

- ① On/off log
- ② Power status
- ③ Light Mode
- ④ Child Lock

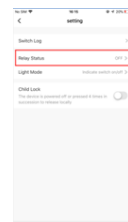

Other Function

1. Linkage alarm setting

To connect two Sensors via scene setting.

2. Device sharing

Allow others to control the device

3. Push notification

Open/close push notification

4. Remove device

Restore default settings; Delete and add the device again to clear the record by APP.



Smart Home Device contains WiFi smart device, Z-Wave device and ZigBee device, give you more choices to create a new smart life.

Wide application on the living room, kitchen, bedroom, bathroom, garage, garden, yard or basement of your home, office, warehouse, chain store...

Make life smarter and more convenient.

